

Pisani Distributing Atlantic Mine, MI



SPECIFICATIONS:

Size: 6,304 sq. ft.
Completion: October 2008
Contact: Gerald Pisani
Phone: (906) 932-0722

PROJECT DESCRIPTION:

Needing to expand their distribution facility in the Houghton County area, Pisani Distribution turned to Division1 Design for an addition to their existing building. The new space includes an open warehouse for storage of palletized products and an 1,600 square foot office space for local personnel. A loading dock was also incorporated into the building's design to allow for multiple trucks to be loaded or unloaded simultaneously. The new warehouse area is a load bearing masonry building with structural bar joists and the office space is wood framed with a wood truss and shingle roof.

Project Includes:

- Reinforced concrete foundation
- Sanitary waste design
- Site drainage design
- Ramped loading dock design

ENGINEERED TO ENSURE SUCCESS

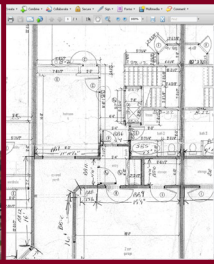

OUR SERVICES

Pre-Planning
Feasibility Studies
Site Analysis
Permitting
Surveying
Environmental Planning
Zoning

ARCHITECTURAL DESIGN

Master Planning
Conceptual Renderings
Design Drawings
Construction Drawings

ENGINEERING

Geotechnical
Structural
Civil

SUSTAINABLE DESIGN

Green building design as
outlined by the U.S.
Green Building Council
Brownfield Assistance

CONSTRUCTION DOCUMENTATION

Drawings
Specifications
Proposal forms

CONSTRUCTION PROCEDURES

On-site QC Inspections
Submittal Review
As-built Drawings
Cost Review

PROPERTY SURVEYING

Land Divisions
- Lot Splits
- Site Condominiums
- Platted Subdivisions
ALTA Land Title Surveys
Mortgage Surveys
Legal Descriptions

DESIGN/ ENGINEERING SURVEYS

Topographic Surveys
- Site Design
- As built locations
Floodplain & Wetland
Mapping

STAKING

Site Grading
Underground Utilities
Building Layout
Roadway Staking
GPS Machine Control
- Terrain Model
Preparation
- Orientation and
initialization of machine
control equipment to site