

# Designed to Deliver Satisfaction

**Hilltop RV** Ishpeming, MI



## **SPECIFICATIONS:**

Size: 11,000 sq. ft.

Project Cost: \$1,010,000

Completion: 2005

## **PROJECT DESCRIPTION:**

Working alongside the Design/Build contractor, Moyle, Inc., Division1 Design provided all engineering and architectural services for this project located along the commercial business district in Ishpeming, Michigan. With a greater need for an outdoor sales area, Division1 Design provided a site design that allowed for ample space for RVs and campers while still maintaining easy access to the building for customer. The building itself provides additional space for smaller show items as well as a maintenance and garage area.

# ENGINEERED TO ENSURE SUCCESS

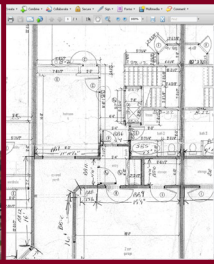

## OUR SERVICES

Pre-Planning  
Feasibility Studies  
Site Analysis  
Permitting  
Surveying  
Environmental Planning  
Zoning

## ARCHITECTURAL DESIGN

Master Planning  
Conceptual Renderings  
Design Drawings  
Construction Drawings

## ENGINEERING

Geotechnical  
Structural  
Civil

## SUSTAINABLE DESIGN

Green building design as outlined by the U.S. Green Building Council  
Brownfield Assistance

## CONSTRUCTION DOCUMENTATION

Drawings  
Specifications  
Proposal forms

## CONSTRUCTION PROCEDURES

On-site QC Inspections  
Submittal Review  
As-built Drawings  
Cost Review

## PROPERTY SURVEYING

Land Divisions  
- Lot Splits  
- Site Condominiums  
- Platted Subdivisions  
ALTA Land Title Surveys  
Mortgage Surveys  
Legal Descriptions

## DESIGN/ENGINEERING SURVEYS

Topographic Surveys  
- Site Design  
- As built locations  
Floodplain & Wetland Mapping

## STAKING

Site Grading  
Underground Utilities  
Building Layout  
Roadway Staking  
GPS Machine Control  
- Terrain Model Preparation  
- Orientation and initialization of machine control equipment to site